

H-Joint Moulding Installation Sheet

The aluminum H-joint moulding is used to conceal the gap between two runs of Resistech™ lap siding. It has a textured finish and is ready for installation. H-joint moulding is sold painted the same colour as your siding.

⚠ IMPORTANT ALWAYS LEAVE A 1/4" TO 5/16" SPACE BETWEEN BOARDS WHEN USING THE H-JOINT MouldING TO HIDE THE GAP BETWEEN TWO RUNS OF LAP SIDING. THIS WILL LEAVE SUFFICIENT SPACE FOR THE SIDING TO EXPAND.

FIGURE 1

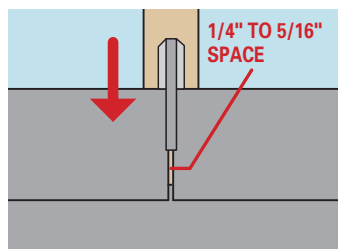

DO NOT IMMEDIATELY NAIL ENDS OF BOARDS NEAR JOINTS.

FIGURE 2

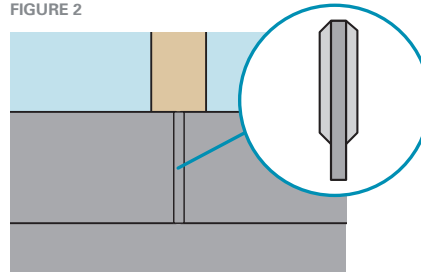

INSERT H-JOINT MouldING, SLIDING IT INTO PLACE FROM TOP TO HIDE GAP.

FIGURE 3

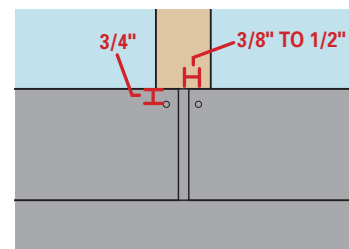

NAIL ENDS OF BOARDS NEAR JOINTS.

FIGURE 4

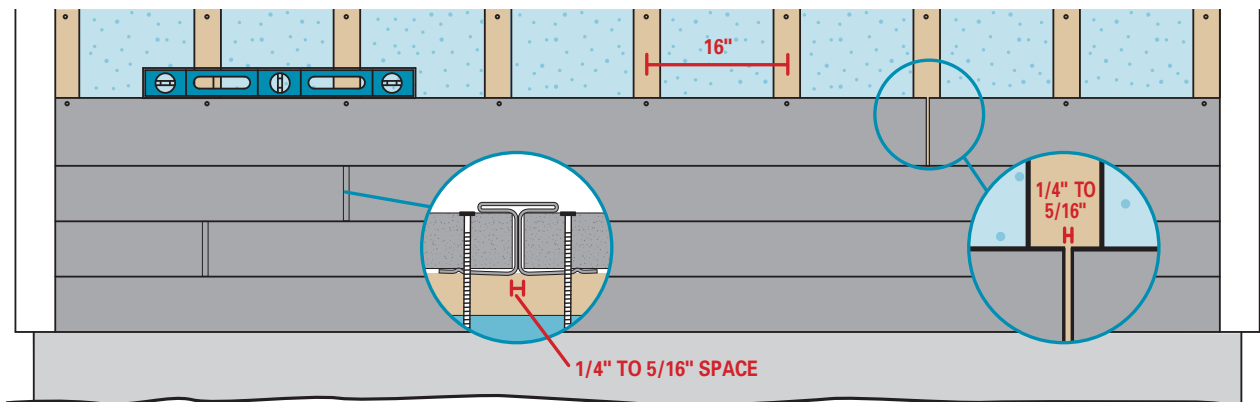

INSTALLING THE H-JOINT MouldING

- Always leave a 1/4" to 5/16" space between boards when installing Resistech™ lap siding with the H-joint moulding. [FIGURE 1]
- Do not immediately nail the ends of boards near the joints. [FIGURE 1]
- Slide the H-joint moulding into place from the top to hide the gap. [FIGURE 2]
- Nail ends of boards according to the installation instructions. [FIGURE 3]
- Stagger siding joints over successive courses. Joints must fall on the centre of furring strips.