

# "C" Transition Trim

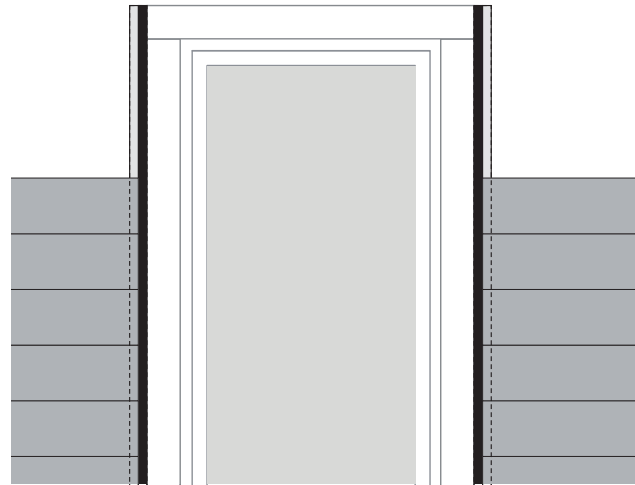
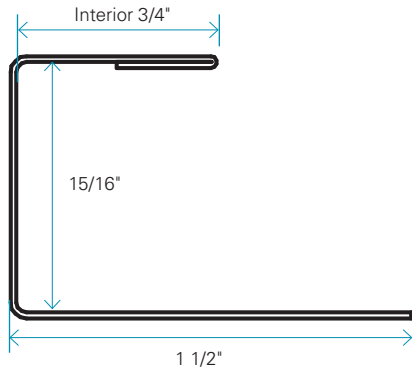

FINISH	ACTUAL DIMENSIONS	LENGTH	INSTALLATION
Steel	3/4" x 15/16"	10'	Vertically

## General Specifications

Steel "C" transition trim, used for finition between Maibec Resistech™ lap siding and openings. Does not require the application of sealant between the transition trim and the siding.

### PACKAGING

- Pieces of 10'

### AVAILABLE COLOUR

- Black

For exterior use only.

### INSTALLATION

- Leave a spacing of 1/4" between the lap siding and the bottom of the "C" transition trim.