

Board & Batten

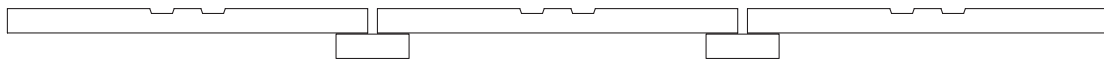

Nominal dimensions	Actual dimensions	Overlap	Exposed surface	Conversion factor
Board: 1" x 10" Batten: 1" x 2"	$\frac{5}{8}$ " x 9" $1\frac{1}{16}$ " x $1\frac{5}{8}$ "		9 $\frac{7}{8}$ " (including the batten)	1.24

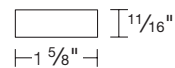
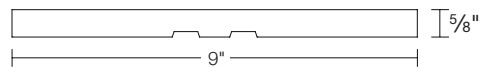
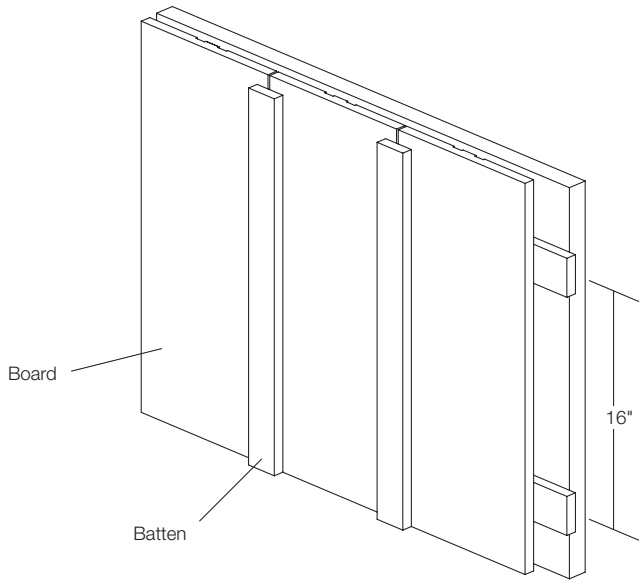