

Installation Guide

Before you begin, take the time to read this entire guide to clearly understand the requirements and steps to follow for proper installation.

i Warning

Do not install defective material. maibec will only replace defective material if it is notified prior to installation. For more details, contact us.

Before you begin, consult your national, provincial and local building codes for requirements regarding the installation of siding, sheathing membrane (housewrap), caulking, etc. Follow the manufacturer's instructions for installing the sheathing membrane and applying caulking.

For more information, consult the Government of Canada's *National Model Construction Codes* at <http://www.nationalcodes.nrc.gc.ca>.

For exterior use only.



i Storage

- Store the siding in a dry and ventilated area. Do not place it directly on the ground.
- Always cover the siding after a day's work.

1 Wall Preparation

- When installing maibec siding, it is preferable to do so over a standard 16" (406 mm) on centre stud built wall with OSB (Oriented Strand Board) sheathing or plywood, and an approved breather membrane. Use 1" x 3" (25 x 76 mm) furring strips. They must be kiln-dried, straight, without splits or nail holes to ensure a proper fastening base.
- The sheathing membrane and flashing must be installed according to building codes and the manufacturer's instructions.
- Use approved exterior tape around windows, doors and any opening to ensure a tight seal with the sheathing membrane.
- i** • Install flashing over the openings and in the areas where moisture drainage is needed. The siding must be installed over furring strips to ensure airflow, allow for moisture drainage and reduce the risk of premature aging.
- To keep insects out, you can staple screening at the base of the wall. Fold back and fasten over the furring strips before installing the first row of siding.
- Verify the structural integrity of the wall, making certain that it is solid, straight and ready for siding to be installed. Verify that the wall's moisture drainage is ensured by a properly installed sheathing membrane and appropriate flashing.

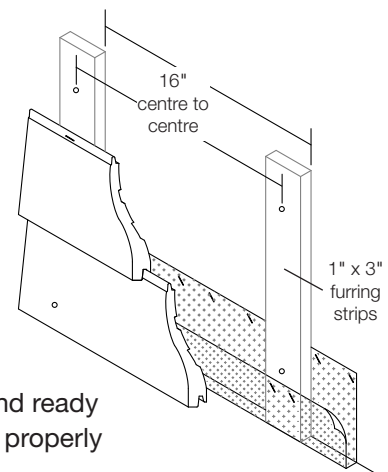

NOTE : If you are using insulating concrete forms (ICF), foam sheathing or Home Slicker®, please contact maibec for technical assistance.

i important : Must be followed. Failure to follow maibec's mandatory installation and storage requirements will void the warranties. Consult the building codes applicable to your region.

Wall Preparation (continued)

Allow a minimum clearance of:

- 8" (203 mm) from the ground,
- 1" (25 mm) from adjacent horizontal structures (e.g. deck),
- 2" (51 mm) from roof shingles.

NOTE: If you are using insulating concrete forms (ICF), foam sheathing or Home Slicker®, please contact maibec for technical assistance.

2 Before You Begin, Make Sure:

To plan the distribution of boards on the walls. First, check the tally on the pallet identifying the product and the number of boards in each length. Position boards over the wall area so as to limit the number of joints and cuts. Use longer boards above and below windows and on large areas. Use short segments for small areas such as spaces between doors and windows. Alternate board lengths to avoid joint alignment.

3 End Joints

End joint - board to board :

We recommend to join the boards, using a 45° angle bevel cut, placed evenly over furring strip. You can also use a 90° angle. Apply touch-up stain as recommended. No caulking necessary.

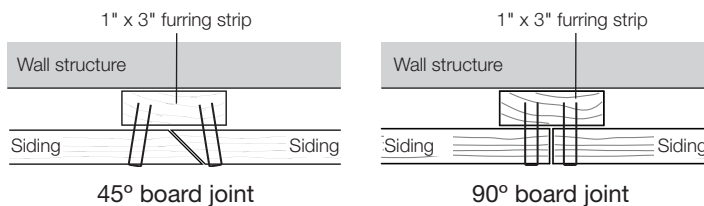

You must cut on the hidden side of the board.

End joint - board to mouldings :

The board is cut at a 90° angle, butted to the moulding. Apply touch-up stain as recommended.

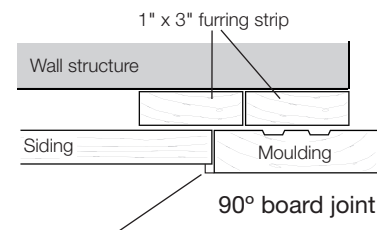

Apply caulking to the joint according to building codes and the manufacturer's recommendations.

4 Touch-Up Stain

- Apply touch-up stain to all cut or planed surfaces and to all bare wood, even if it is not visible once the siding is installed. It is imperative to touch-up boards before they are installed. The heads of the nails used for the first and last course, and for mouldings, could be damaged during installation. They will need to be touched-up. **Touch-up stain is only meant to be used in the area in need of it. It must not, under any circumstance, be applied over non-damaged factory coated material.** For more information, see the touch-up guide that comes with the touch-up stain cans or go to www.maibec.com.

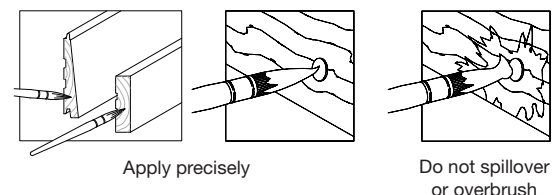

i important: Must be followed. Failure to follow maibec's mandatory installation and storage requirements will void the warranties. Consult the building codes applicable to your region.

5 Fasteners and Furring Strips

Staples

- Use stainless steel staples for the intermediate courses.
- Staples have to be a minimum of $\frac{3}{8}$ " to $\frac{7}{16}$ " (10 mm to 11 mm) wide x $1 \frac{1}{4}$ " to $1 \frac{1}{2}$ " (32 mm to 38 mm) long.
- Staple at 30°.

Nails

For the first and last course or under windows, use maibec twice hot-dipped zinc galvanized or stainless steel flat textured head ring shank nails that are corrosion resistant and colour-matched to the siding.

Lengths:

- 2" (51 mm) for the first and last course,
- 3" (76 mm) for the mouldings.

Ensure staples or nails have a minimum penetration of $1 \frac{1}{4}$ " (30 mm) in a solid substrate.

The staple or the nail must be driven so that the head sits flush on the wood's surface.

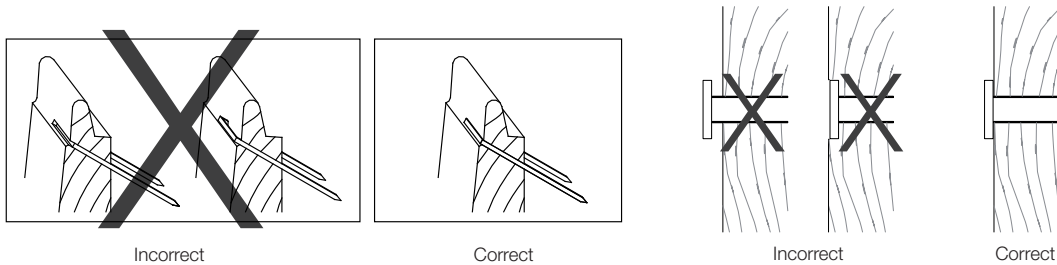

Use 1" x 3" (25 x 76 mm) ($\frac{3}{4}$ " thick) furring strips. They must be kiln-dried, straight, without splits or nail holes, to ensure a proper nailing base.

Horizontal Installation. Vertical Furring Strips.

Nail furring strips vertically on 16" centres.

Starter course and last course: nail every 16" (406 mm), $\frac{3}{4}$ " to 1" (19 mm to 25 mm) from the base of the board or high quality exterior glue.

Intermediate courses: staple every 16" (406 mm) at a 30° angle.

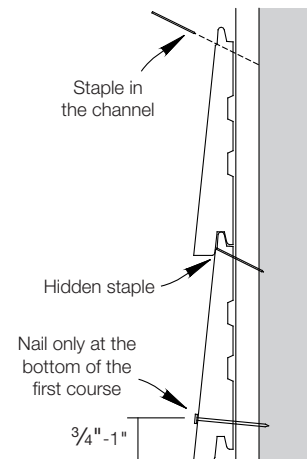

NOTE: The maibec® warranty is conditional to the use of stainless steel or hot-dipped galvanized staples and maibec twice hot-dipped zinc galvanized or stainless steel flat textured head ring shank nails.

6 Starter Course

- i** To properly repel water from the wall, the starter board must extend past the nailing furring strip by 1/4" (6 mm), but must not exceed 1" (25 mm). The board must have a minimum clearance of 8" (203 mm) with the ground surrounding the building. The siding should never touch the ground.

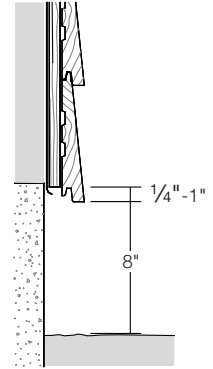

7 Subsequent Courses

- i** Due to variations in board sizes, you must check course alignment every 3 or 4 courses. A variance of 3/16" between boards is considered normal.

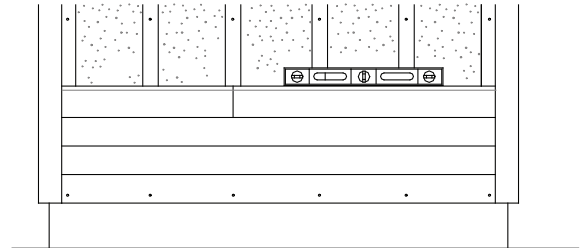

8 Corners Finish Details

- i** Corner trims must be installed before the siding is installed. Here are a few ways to install them:

Inside Corner (2" x 2")

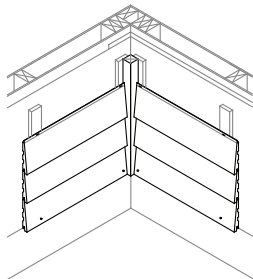

2" Inside or Outside Corner

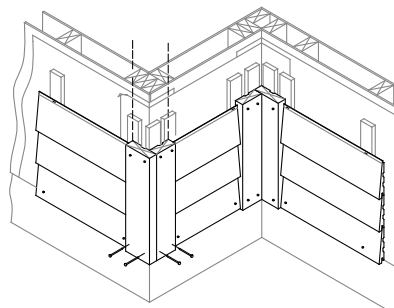

Nailing Mouldings

Every 16" (406 mm), fasten 2 nails.

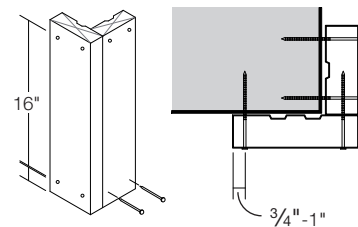

i important : Must be followed. Failure to follow maibec's mandatory installation and storage requirements will void the warranties. Consult the building codes applicable to your region.

9 Window Finish Details

1. Choosing a Window

- If you plan to install window mouldings, you must choose the window with this in mind. The window frame depth must be equivalent to the wall width, including the support furring strips, but not the siding. Therefore, the window frame must extend 3/4" (19 mm) beyond the wall, which is the thickness of the furring strip. The window sill should extend at least 3" (76 mm) beyond the wall.
- If the siding butts to the frame, the frame must be as deep as the thickness of the wall plus the thickness of the siding.

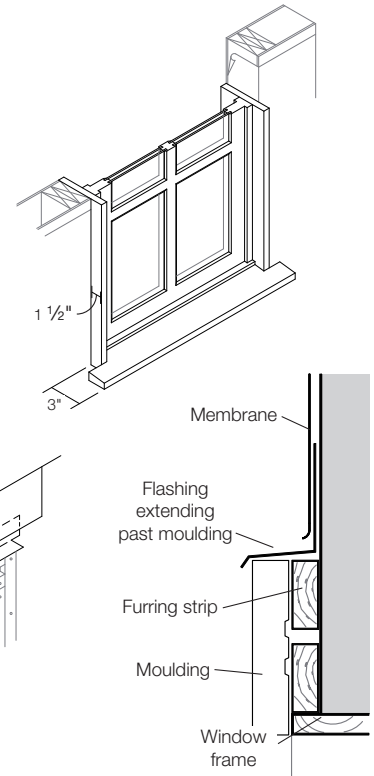

i 2. Header Flashing

Steel flashing is essential to keep moisture at bay. It must be installed to cover and extend beyond the header moulding.

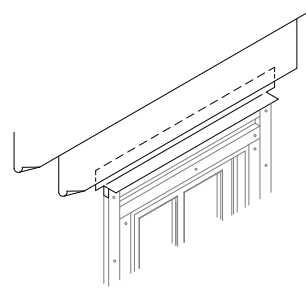

i 3. Siding Installation

Install the siding once the mouldings are installed.

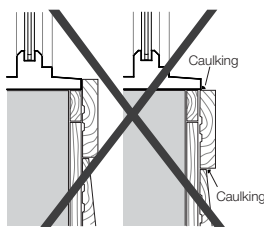

Incorrect

All flat horizontal surfaces (such as a window sill trim) are prone to water or snow accumulation. The use of flashing, caulking or a miter cut on the trim is necessary to prevent this accumulation.

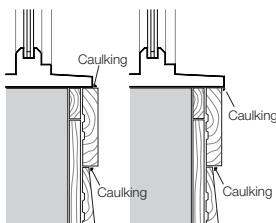

Correct

In these applications, the window sill trim is not subject to water or snow accumulation.

Leave a 1/4" to 1/2" (6 to 13 mm) space between the siding and the flashing for effective moisture drainage.

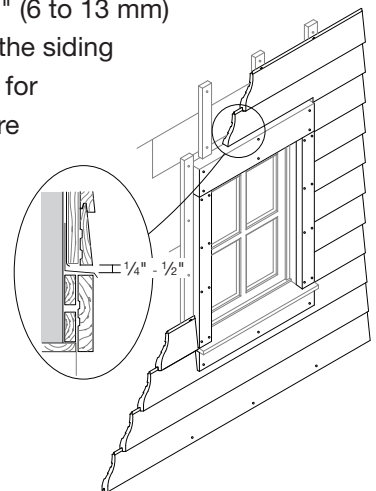

i important : Must be followed. Failure to follow maibec's mandatory installation and storage requirements will void the warranties. Consult the building codes applicable to your region.

10 Top of The Wall Finish Details

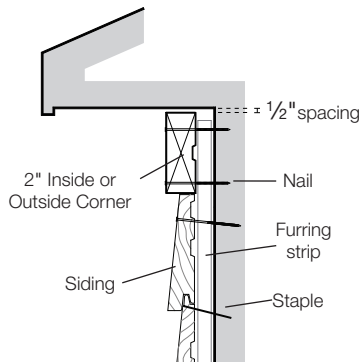

The way to finish the top of a wall is to install a moulding and have the siding butt directly to it. A 4" (102 mm) wide siding piece is the norm for this type of application. To facilitate air flow behind the siding, it is important to leave a 1/2" (13 mm) gap between the moulding and the soffit.

11 Dormer/Roof Junction Finish Details

- i** The siding must be spaced at least 2" (51 mm) when it ends adjacent to the roof surface. The spacing is necessary to properly drain water and prevent the build-up of ice against the siding.

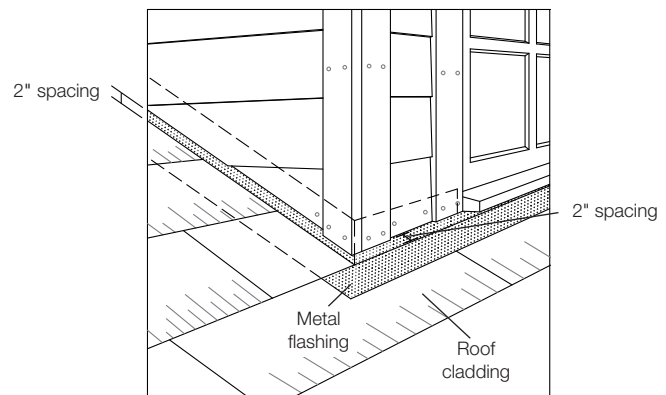

Maintenance

- As with all sidings, dirt build-up can occur; this could be due to a number of factors such as surrounding vegetation, dust or air pollution.
- Periodic cleaning can be required. Wash down with a hose or a mild detergent to avoid damaging the stain. Do not use a pressure washer. Contact us for more details.
- See the maibec Sidings Maintenance Guide for details.**

i important : Must be followed. Failure to follow maibec's mandatory installation and storage requirements will void the warranties. Consult the building codes applicable to your region.

WARRANTY*

60 YEARS against wood decay

15 YEARS on solid stain 2 coats **+15 YEARS** extended warranty

8 YEARS on natural tones stain

* Some restrictions apply.