

# H-Joint Molding Installation Sheet

The aluminum H-joint molding is used to conceal the gap between two runs of Resistech™ lap siding. It has a textured finish and is ready for installation. H-joint molding is sold painted the same color as your siding.

**⚠ IMPORTANT** ALWAYS LEAVE A 1/4" TO 5/16" SPACE BETWEEN BOARDS WHEN USING THE H-JOINT MOLDING TO HIDE THE GAP BETWEEN TWO RUNS OF LAP SIDING. THIS WILL LEAVE SUFFICIENT SPACE FOR THE SIDING TO EXPAND.

FIGURE 1

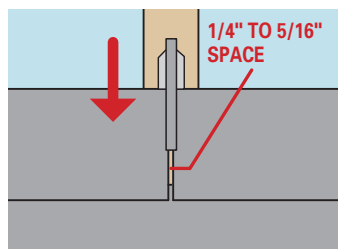

DO NOT IMMEDIATELY NAIL ENDS OF BOARDS NEAR JOINTS.

FIGURE 2

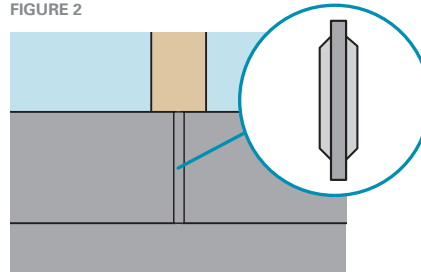

INSERT H-JOINT MOLDING, SLIDING IT INTO PLACE FROM TOP TO HIDE GAP.

FIGURE 3

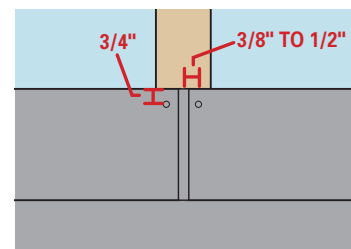

NAIL ENDS OF BOARDS NEAR JOINTS.

FIGURE 4

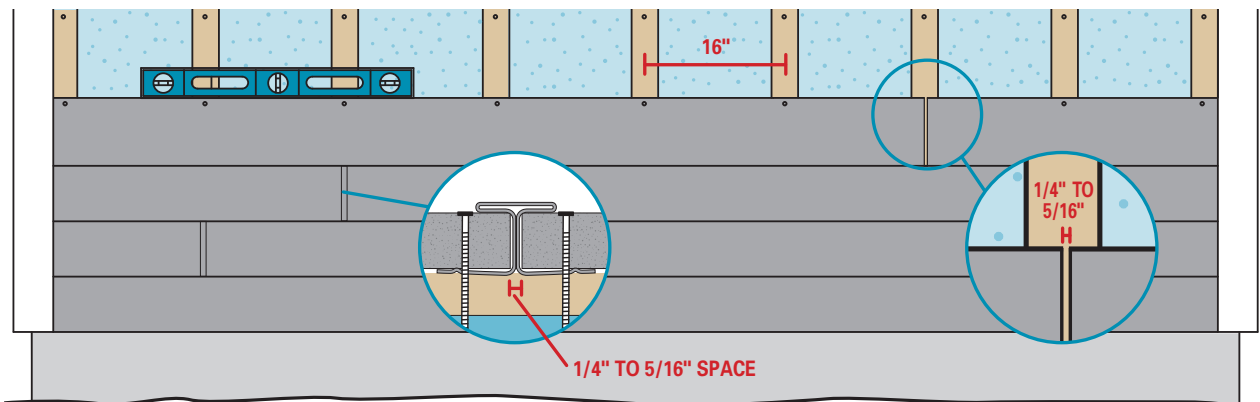

## INSTALLING THE H-JOINT MOLDING

- Always leave a 1/4" to 5/16" space between boards when installing Resistech™ lap siding with the H-joint molding. [FIGURE 1]
- Do not immediately nail the ends of boards near the joints. [FIGURE 1]
- Slide the H-joint molding into place from the top to hide the gap. [FIGURE 2]
- Nail ends of boards according to the installation instructions. [FIGURE 3]
- Stagger siding joints over successive courses. Joints must fall on the centre of furring strips.